

REMOVAL

1. w/ Airbag:

REMOVE STEERING WHEEL PAD

NOTICE:

- If the airbag connector is disconnected with the ignition switch at ON or ACC, DTCs will be recorded.
 - Never use airbag parts from another vehicle. When replacing parts, replace with new ones.
- Place the front wheels facing straight ahead.
 - Using a torx socket wrench, loosen the 2 torx screws until the groove along the screw circumference catches on the screw case.

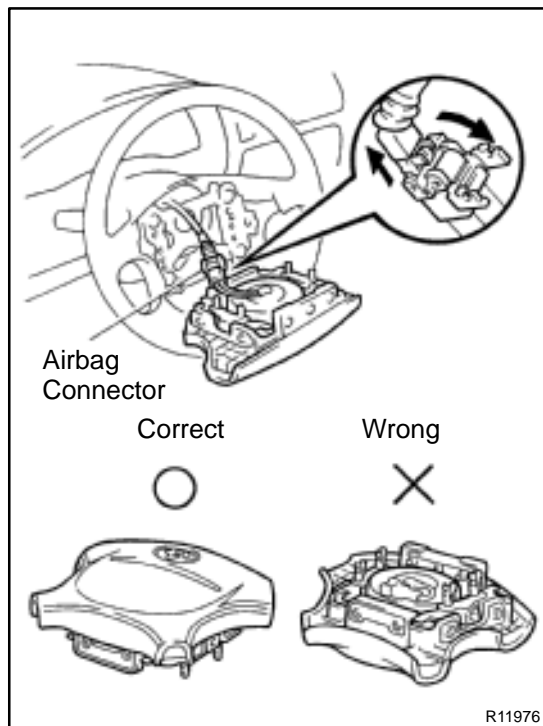

- Pull out the wheel pad from the steering wheel and disconnect the airbag connector.

CAUTION:

- When storing the wheel pad, keep the upper surface of the pad facing upward.
- Never disassemble the wheel pad.

NOTICE:

When removing the wheel pad, take care not to pull the airbag wire harness.

2. w/o Airbag:

REMOVE STEERING WHEEL PAD

- Remove the screw.
- Remove the pad.
- Disconnect the terminal.

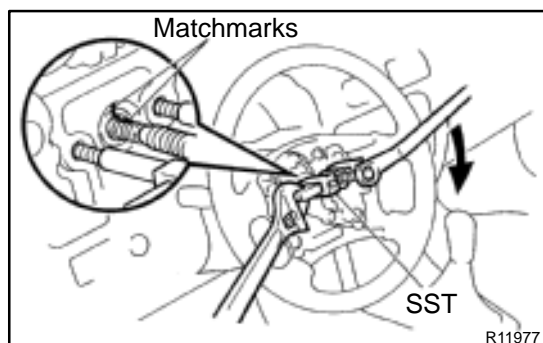

3. REMOVE STEERING WHEEL

- Disconnect the connector.
- Remove the steering wheel set nut.
- Place matchmarks on the steering wheel and main shaft assembly.
- Using SST, remove the wheel.
SST 09950-50010 (09951-05010, 09952-05010, 09953-05020, 09954-05020)

4. REMOVE FRONT DOOR SCUFF PLATE AND COWL SIDE TRIM

Remove the clip and trim.

5. REMOVE LOWER LH INSTRUMENT COVER AND LH INSTRUMENT PANEL LOWER PAD INSERT

- (a) Remove the 2 screws and disconnect the hood lock release lever from the instrument cover.
- (b) Remove the 2 opening covers from the instrument cover.
- (c) Remove the 4 instrument cover set bolts.
- (d) Remove the lower pad insert from the instrument cover.

6. DISCONNECT INSTRUMENT PANEL JUNCTION BLOCK

Remove the 3 screws.

7. REMOVE NO.2 HEATER TO REGISTER DUCT

Remove the clip.

8. REMOVE CENTER UPPER INSTRUMENT CLUSTER FINISH PANEL

- (a) Remove the screw.
- (b) Disconnect the connector.

9. REMOVE UPPER AND LOWER COLUMN COVERS

- (a) Remove the 3 screws from the lower cover.
- (b) Remove the screw from the upper cover.

10. REMOVE COMBINATION SWITCH WITH SPIRAL CABLE

- (a) Disconnect the 3 connectors.
- (b) w/ Airbag:
Disconnect the airbag connector.
- (c) Remove the 3 screws.

11. w/ Airbag:
REMOVE SPIRAL CABLE
 (See page [BE-14](#))

NOTICE:

Do not disassemble the cable or apply oil to it.

12. REMOVE COLUMN HOLE COVER

Remove the 2 bolts and nut.

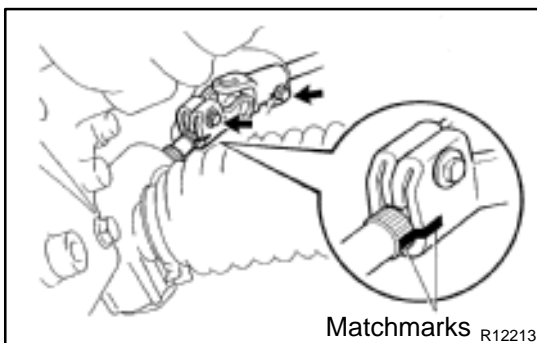
**13. DISCONNECT SLIDING YOKE**

- (a) Place matchmarks on the sliding yoke and control valve shaft.
- (b) Loosen bolt A and remove bolt B.

14. REMOVE SLIDING YOKE

- (a) Remove the bolt A.

15. REMOVE STEERING COLUMN ASSEMBLY

- (a) Disconnect the connectors.
- (b) Remove the 4 column assembly set nuts.